

RENTED



310/20 Convention Centre PI Melbourne VIC

2 🛏 2 🚿 2 🚗

(Photos for reference)

Experience the best of city-fringe living with this rare double-storey townhouse, perfectly positioned with uninterrupted views of the Yarra River and Melbourne's skyline.

The ground floor features a light-filled open-plan living and dining area, complemented by a sleek European kitchen with premium appliances. There is also a versatile space ideal for a study or additional seating area. Step outside to a private courtyard and a north-facing balcony, perfect for entertaining or simply enjoying the view.

Type : Townhouse

Price : \$ 990 per week

View : <https://www.rentedpm.com.au/8697455>



Cindy Wei
03 9349 2645

[For full version visit the website](#)

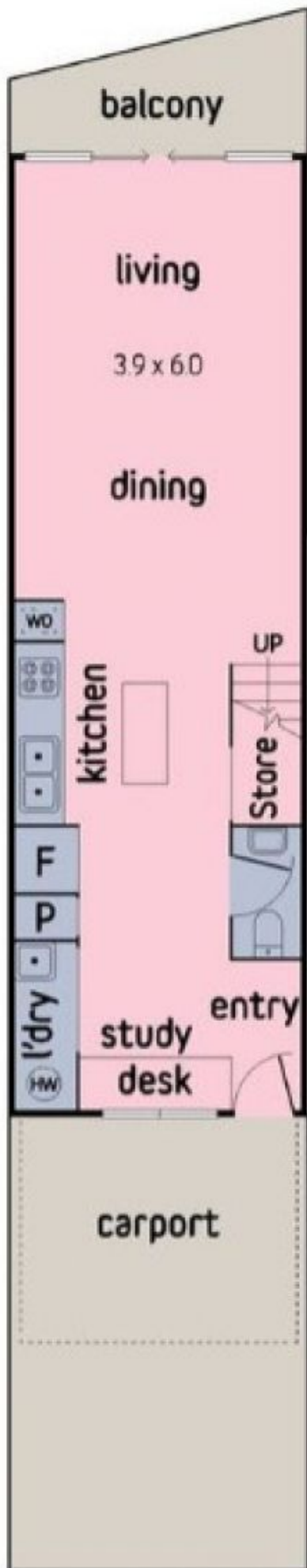

GROUND FLOOR

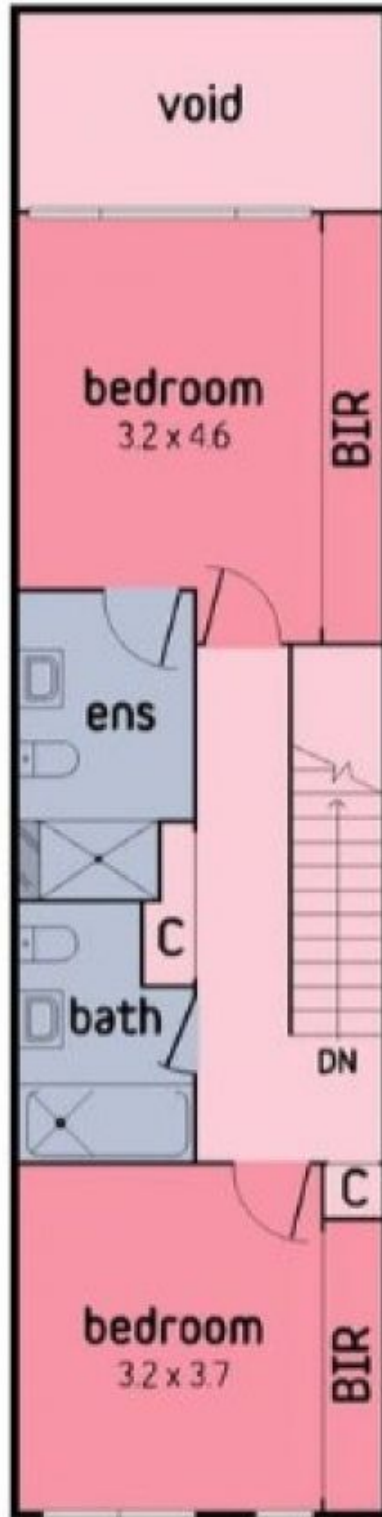

FIRST FLOOR

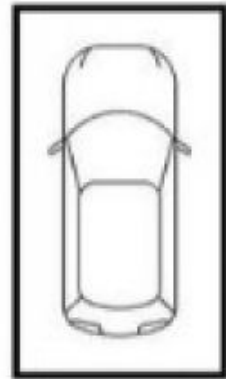

2nd car spot
(not in position)

